

BYLAW NO. 4-02

A bylaw of the Rural Municipality of Viscount No. 341 concerning the **Erection of Highway Traffic Signs.**

Whereas: the Rural Municipality of Viscount No. 341 is allowed under **Section 302** ^{303 R} of the **Rural Municipality Act, 1989** to, erect any signs, on any municipal road within the Municipality.

Now Therefore; The Council of the Rural Municipality of Viscount No. 341 in the Province of Saskatchewan enacts as follows:

1. In this bylaw the expression "Road" means any public highway within the Municipality as defined in The Highways and Transportation Act, 1997, other than a Provincial Highway as designated pursuant to such Act.
2. "Stop" signs shall be erected at the intersection of roadways at the following locations:

<u>LOCATION OF INTERSECTION</u>	<u>SIDE OF ROAD</u>	<u>DIRECTION FROM INTERSECTION</u>	<u>FACING TRAFFIC FROM</u>
NE-20-36-26-W2	SOUTH	WEST	WEST
SW-28-36-26-W2	NORTH	EAST	EAST
250 Meters East of the North West corner of the NW-12-36-26-W2	SOUTH	WEST	WEST

3. "Yield" signs shall be erected at the intersection of roadways at the following locations:

<u>LOCATION OF INTERSECTION</u>	<u>SIDE OF ROAD</u>	<u>DIRECTION FROM INTERSECTION</u>	<u>FACING TRAFFIC FROM</u>
300 meters North of the South West corner of the SW-28-32-26-W2	EAST	SOUTH	SOUTH
300 meters West of the South East corner of the SE-29-32-26-W2	NORTH	EAST	EAST
NW-07-33-25-W2	EAST	SOUTH	SOUTH
NW-09-33-25-w2	EAST	SOUTH	SOUTH
SE-17-33-25-W2	WEST	NORTH	NORTH
NE-31-33-25-W2	SOUTH	WEST	WEST
NE-08-33-26-W2	SOUTH	WEST	WEST
SE-13-33-26-W2	WEST	NORTH	NORTH
SE-14-33-26-W2	WEST	NORTH	NORTH
SW-16-33-26-W2	NORTH	EAST	EAST
NE-20-33-26-W2	SOUTH	WEST	WEST
NW-20-33-26-W2	EAST	SOUTH	SOUTH
SE-30-33-26-W2	WEST	NORTH	NORTH
SW-28-33-26-W2	NORTH	EAST	EAST
SW-05-34-25-W2	NORTH	EAST	EAST
NW-07-34-25-W2	EAST	SOUTH	SOUTH
NW-08-34-25-W2	EAST	SOUTH	SOUTH
NW-31-34-25-W2	EAST	SOUTH	SOUTH
NE-34-34-25-W2	SOUTH	WEST	WEST
SW-04-34-26-W2	NORTH	EAST	EAST
NE-08-34-26-W2	SOUTH	WEST	WEST
NW-08-34-26-W2	EAST	SOUTH	SOUTH
NW-12-34-26-W2	EAST	SOUTH	SOUTH
SE-13-34-26-W2	WEST	NORTH	NORTH
SE-15-34-26-W2	WEST	NORTH	NORTH
SW-16-34-26-W2	NORTH	EAST	EAST
SE-18-34-26-W2	WEST	NORTH	NORTH
NE-19-34-26-W2	SOUTH	WEST	WEST
SW-21-34-26-W2	NORTH	EAST	EAST
NE-29-34-26-W2	SOUTH	WEST	WEST
NE-31-34-26-W2	SOUTH	WEST	WEST
300 meters South of the North East corner of the NE-32-34-26-W2	WEST	NORTH	NORTH
300 meters East of the North West corner of the NW-33-34-26-W2	SOUTH	WEST	WEST
NW-33-34-26-W2	EAST	SOUTH	SOUTH

eww

SW-01-35-25-W2	NORTH	EAST	EAST
300 meters North of the South West corner of the			
SW-04-35-25-W2	EAST	SOUTH	SOUTH
300 meters West of the South East corner of the			
SE-05-35-25-W2	NORTH	EAST	EAST
NE-08-35-25-W2	SOUTH	WEST	WEST
SW-16-35-25-W2	NORTH	EAST	EAST
NE-23-35-25-W2	SOUTH	WEST	WEST
250 meters South of the North East corner of the			
NE-23-35-25-W2	WEST	NORTH	NORTH
250 meters East of the north West corner of the			
NW-24-35-25-W2	SOUTH	WEST	WEST
SW-25-35-25-W2	NORTH	EAST	EAST
NE-32-35-25-W2	SOUTH	WEST	WEST
SE-04-35-26-W2	WEST	NORTH	NORTH
SW-04-35-26-W2	NORTH	EAST	EAST
NE-32-35-26-W2	SOUTH	WEST	WEST
SW-04-36-25-W2	NORTH	EAST	EAST
NE-08-36-25-W2	SOUTH	WEST	WEST
NW-11-36-25-W2	EAST	SOUTH	SOUTH
NW-12-36-25-W2	EAST	SOUTH	SOUTH
SW-16-36-25-W2	NORTH	EAST	EAST
NE-20-36-25-W2	SOUTH	WEST	WEST
SW-28-36-25-W2	NORTH	EAST	EAST
SE-02-36-26-W2	WEST	NORTH	NORTH
SW-04-36-26-W2	NORTH	EAST	EAST
300 meters North of the South West corner of the			
SW-13-36-26-W2	EAST	SOUTH	SOUTH
300 meters South of the North East corner of the			
NE-14-36-26-W2	WEST	NORTH	NORTH
NW-16-36-26-W2	EAST	SOUTH	SOUTH
NW-18-36-26-W2	EAST	SOUTH	SOUTH
SE-20-36-26-W2	WEST	NORTH	NORTH
SE-21-36-26-W2	WEST	SOUTH	SOUTH

4. All signs erected pursuant to Section 2 and 3 hereof shall be erected not less than two meters and not more than fifteen meters from the near edge of the intersection roadway.
5. The provisions of The Highway Traffic Act , 1997, shall apply, wherever applicable, to every sign erected pursuant to Section 2 and 3.
6. No person shall alter, damage, remove, deface, knock down or tamper with any sign erected pursuant to this bylaw.
7. Any person who violates any provisions of this bylaw shall be guilty of an offense and shall be liable on summary conviction to the penalties in the General Penalty Bylaw of the Municipality,
8. Bylaw No. 4-91 is hereby repealed.

THE RURAL MUNICIPALITY OF VISCOUNT NO. 341



 REEVE

SEAL



 ADMINISTRATOR

Read a third time and adopted this
 11th day of June, 2002.

Certified a True Copy of Bylaw
 No. 4-02 adopted by resolution
 of Council this 11th day of June, 2002.

SEAL



 ADMINISTRATOR

**Description of Signs Placed at a Normal
Intersection of Roads.**

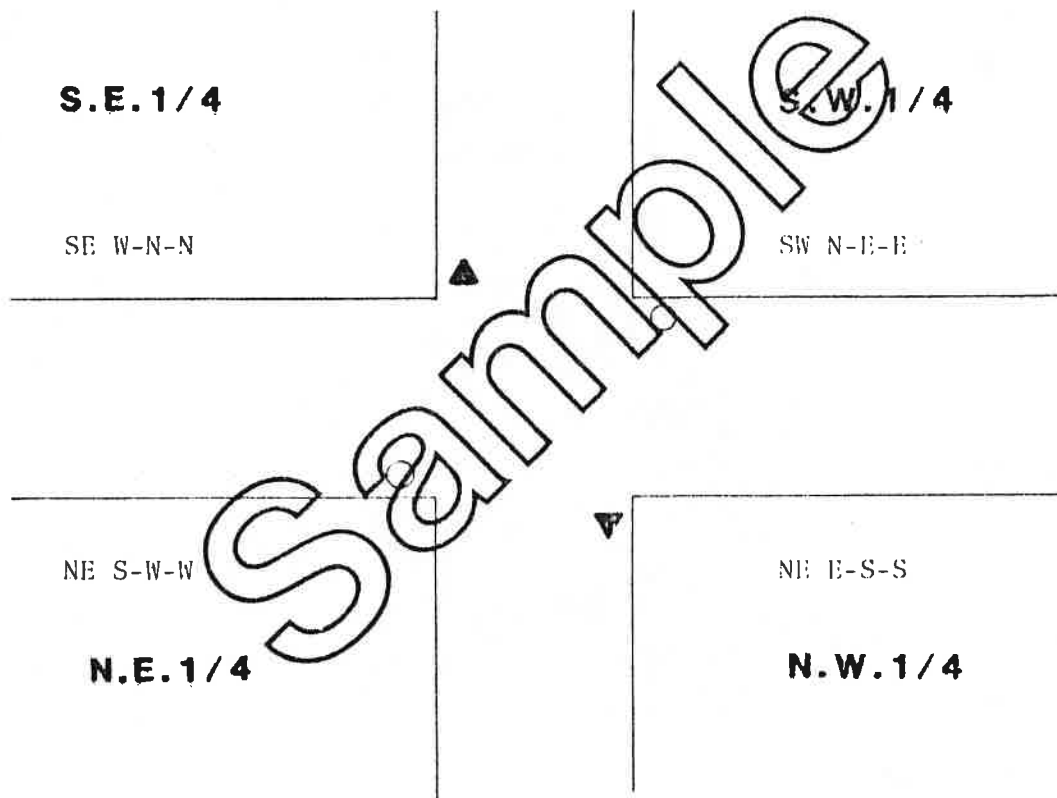

The erection of stop and yield signs in hamlets should be located by street intersection. In accordance with the sketch set out below the stop signs location would be described as follows:

LOCATION OF INTERSECTION	SIDE OF ROAD	DIRECTION FROM INTERSECTION	FACING TRAFFIC
Intersection of Main Street and 1st Avenue	South side of 1st Avenue	West side of Main Street	West
Intersection of Main Street and 1st Avenue	North side of 1st Avenue	East side of Main Street	East

Sample

Hamlet

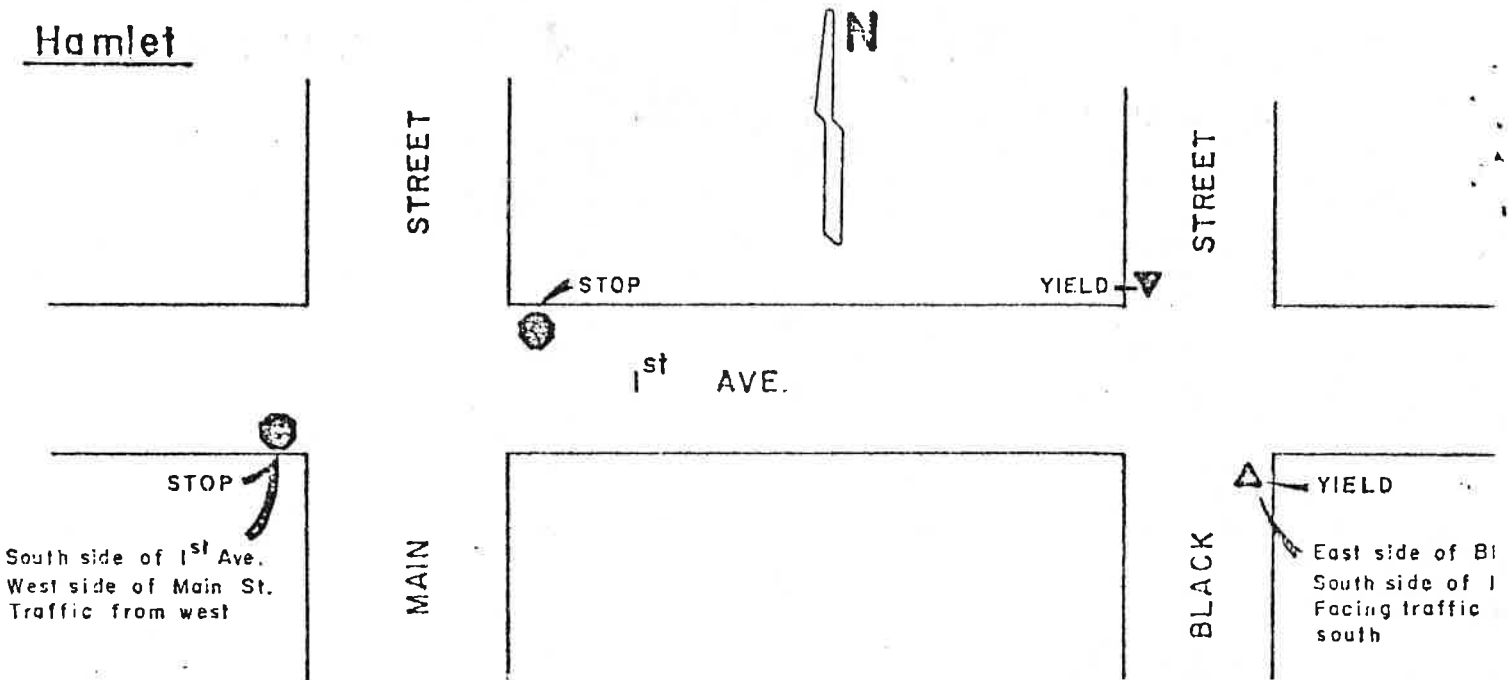

STOP

South side of 1st Ave.
West side of Main St.
Traffic from west

YIELD

East side of B1
South side of 1
Facing traffic
south

Signs Placed on Curves:

